

Build Better.

BENEX

Basement Wall System

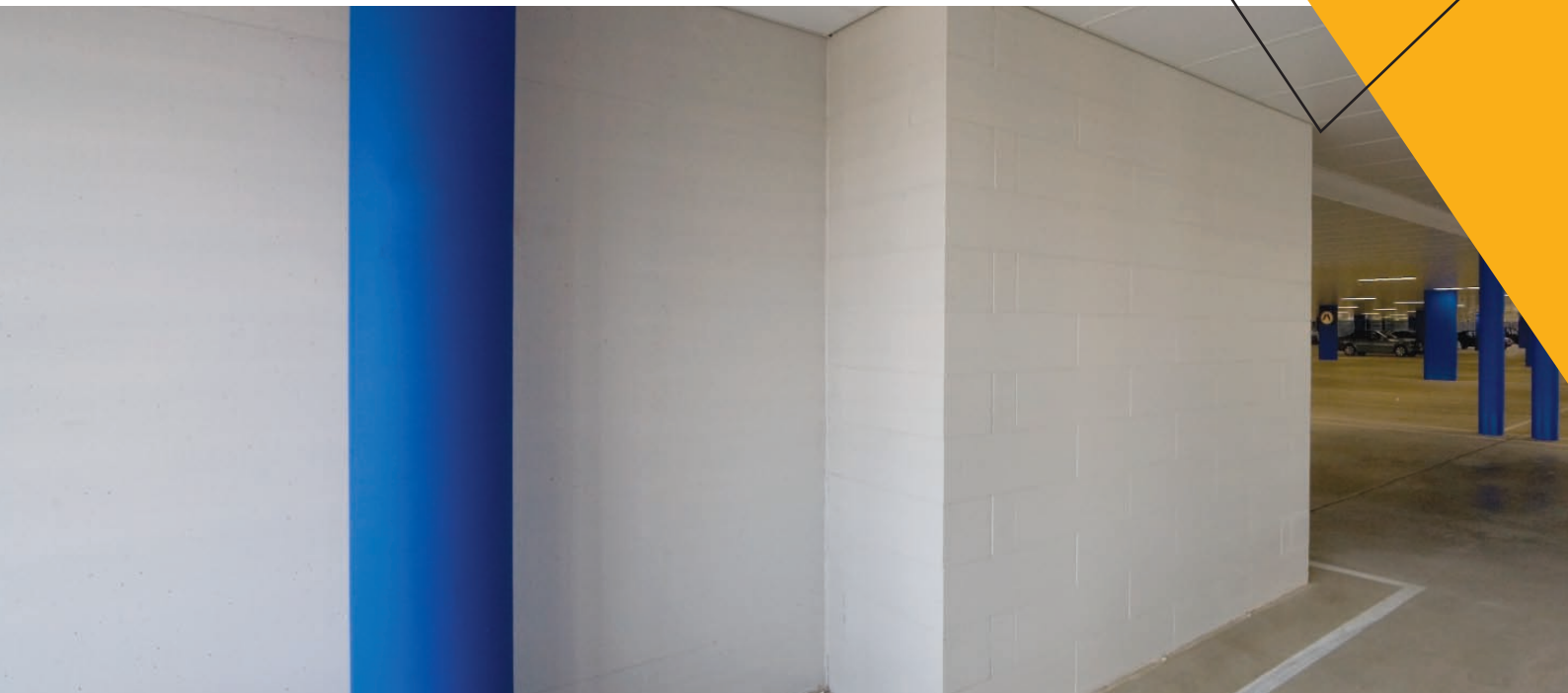

Benex provides a solution to the many challenges associated with basement construction.

Benex can save you time, money and effort by minimising excavation, reducing waterproofing requirements, providing an aesthetic wall unpainted, and speed of wall construction.

Benex utilises a 'closed cell' mix which results in a lightweight product solution. Unlike traditional masonry products that draw in moisture, the unique Benex mixture results in an innovative block that is impervious to water.

- ✓ No additional tanking/waterproofing
- ✓ Reduced excavation costs
- ✓ Aesthetic finish
- ✓ Speed of construction
- ✓ Labour savings
- ✓ No rising damp, mould or mildew
- ✓ Ease of fixings and adding services
- ✓ Choice of finishes

Basement Wall Comparison

Benex Basement Wall

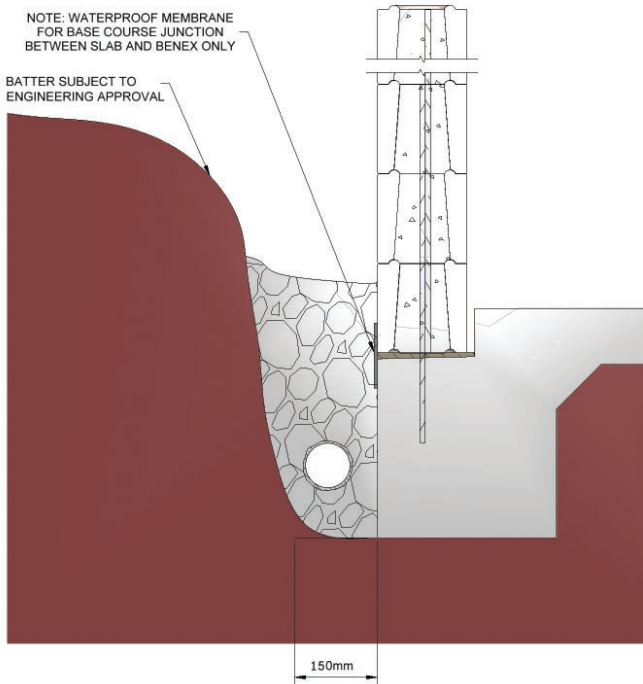

Concrete Block Basement Wall

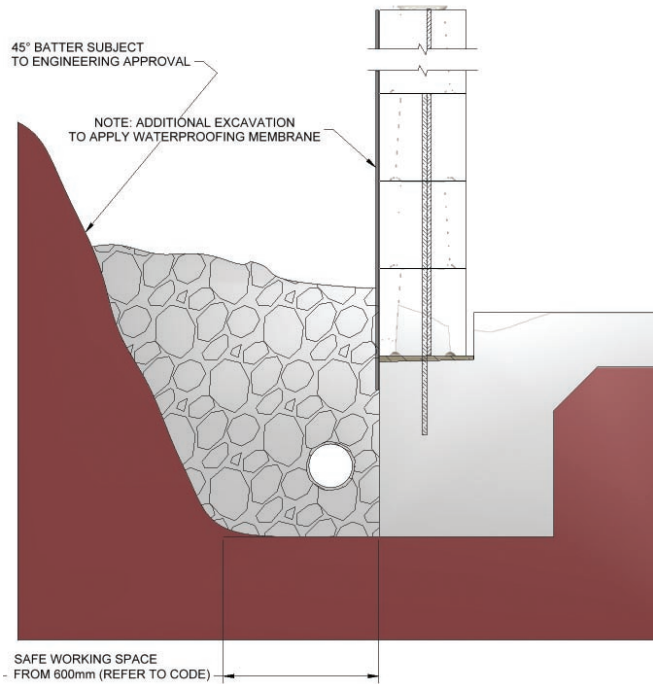

Benex is ideal for use in basements as the perimeter wall. The savings in tanking and excavations are significant.

Waterproofing

Benex as a stand alone product, is impervious to water, as is the Benex mix adhesive. The most susceptible place for water to penetrate any constructed block wall is within its joints. A Benex installer runs two continuous beads of Benex mix adhesive all around the blocks ensuring water cannot penetrate at the joints.

With Benex there is no need to apply any waterproof membrane. Only the base course where the Benex wall meets the slab requires traditional mortar with additives for waterproofing. The saving in tanking alone is in excess of \$50m².

Excavation

Excavation can be timely and expensive. The Benex wall system can reduce time and minimise excavation costs. A traditional concrete block work basement requires excavation of 600mm* and then battered off at 45 degrees** to ensure a safe working space for the installer of the waterproofing membrane. The Benex Wall System reduces the amount of excavation required around the perimeter of the basement due to the fact the junction between the base course and slab or footing is tanked. This then eliminates the need for the installer to enter behind the wall, and also saves significant costs and man-hours as there is no need to apply a waterproofing membrane.

Aesthetic Wall Finish

Many traditional masonry products absorb moisture making it difficult to paint as moisture can act as a bond breaker over time enabling paint to simply flake off. Benex does not absorb moisture making it an attractive solution to the painter and the finished wall alike. Issues such as rising damp and mould forming are also alleviated for this reason. The Benex Wall System doesn't age like other alternate products. The Benex Wall System can be used as a finished wall without any additional paints or renders.

*Check with your state for current regulations

**Check with your engineer for regulations